

SANTA ROSA MARKETPLACE

2280 Santa Rosa Avenue Santa Rosa, CA



12,500 SF JR. ANCHOR AVAILABILITY



JOHN SCHAEFER
(415) 235-8115
john@keystonerea.com
CA LIC: 0125740

GREY BRADSHAW
(415) 728-7036
grey@keystonerea.com
CA LIC: 02200913

 **KEYSTONE**
REAL ESTATE ADVISORS
CA LIC: 02117431

Keystone Real Estate Advisors
1129 Industrial Avenue, #205
Petaluma, CA 94952
www.keystonerea.com



HIGHLIGHTS

- SANTA ROSA MARKETPLACE IS THE PREMIER REGIONAL SHOPPING CENTER IN SONOMA COUNTY
- THIS COSTCO AND TARGET ANCHORED RETAIL SHOPPING CENTER IS HOME TO OVER 27 NATIONAL RETAILERS WITH OVER 544,234 SF OF RETAIL SPACE
- STRATEGICALLY LOCATED ALONG SONOMA COUNTY'S "RETAIL ROW" WITH DIRECT ACCESS TO HIGHWAY 101
- STRONG REGIONAL DRAW FROM NEIGHBORHOODS IN PROXIMITY WITH A RESIDENTIAL POPULATION OF OVER 200,000
- HIGHEST VOLUME SHOPPING CENTER IN THE NORTH BAY
- EXCELLENT VISIBILITY FROM SANTA ROSA AVENUE- 28,093 VPD
- UPCOMING AVAILABILITY:
 - MAJOR 3-LEASE EXPIRATION 11/30/2025 (±12,500 SF) (CAN BE DEMISED)

| DEMOGRAPHICS | 1 MILE | 3 MILES | 5 MILES |
|-------------------|----------|-----------|-----------|
| 2024 Population | 23,115 | 134,499 | 203,254 |
| No. of Households | 7,494 | 48,200 | 74,806 |
| Avg. HH Income | \$98,348 | \$104,244 | \$116,565 |

Tenants Include:



© 2024 Keystone Real Estate Advisors, Inc. (KREA) The information contained in this document has been obtained from sources believed reliable. While KREA does not doubt its accuracy, KREA has not verified it and makes no guarantee, warranty or representation about it. It is your responsibility to independently confirm its accuracy and completeness. Any projections, opinions, assumptions or estimates used are for example only and do not represent the current or future performance of the property. The value of this transaction to you depends on tax and other factors which should be evaluated by your tax, financial and legal advisors. You and your advisors should conduct a careful, independent investigation of the property to determine to your satisfaction the suitability of the property for your needs. KREA and the KREA logo are service marks of Keystone Real Estate Advisors, Inc. and/or its affiliated or related companies in the United States and other countries. All other marks displayed on this document are the property of their respective owners. Photos herein are the property of their respective owners and use of these images without the express written consent of the owner is prohibited.

JOHN SCHAEFER
 (415) 235-8115
 john@keystonerea.com
 CA LIC: 0125740

GREY BRADSHAW
 (415) 728-7036
 grey@keystonerea.com
 CA LIC: 02200913

KEYSTONE
 REAL ESTATE ADVISORS
 CA LIC: 02117431

Keystone Real Estate Advisors
 1129 Industrial Avenue, #205
 Petaluma, CA 94952
 www.keystonerea.com

SITE MAP & INDEX



Can be demised-see next page

KAWANA SPRINGS ROAD

SANTA ROSA AVENUE

Coming Soon

| SANTA ROSA MARKETPLACE | | |
|------------------------|--------------------------------|------------|
| SUITE ID | TENANT | SIZE (SF) |
| Major A | Best Buy | 42,006 sf |
| Major A2 | Burlington | 31,635 sf |
| Major AB | PetSmart | 15,994 sf |
| Major B | Marshalls | 30,000 sf |
| Major C | Sports Basement | 41,890 sf |
| Major D | Target | 124,319 sf |
| Major E | Costco | 148,027 sf |
| Major 1 | Bevmo! | 18,000 sf |
| Major 2 | Trader Joe's | 15,000 sf |
| Major 3 | Old Navy | 12,500 sf |
| Major 4 | Ulta Beauty | 14,940 sf |
| Shop A1 | Vans | 1,500 sf |
| Shop A2 | Vans | 1,866 sf |
| Shop A3 | Menchie's | 1,400 sf |
| Shop A4 | Chipotle | 2,245 sf |
| Shop A5A | AT&T | 2,249 sf |
| Shop A5A | Laser Away | 1,756 sf |
| Shop A5B | Crumbl Cookie | 1,400 sf |
| Shop A7 | Ohana Hawaiian BBQ | 1,600 sf |
| Shop B1 | Teaspoon | 1,159 sf |
| Shop B2 | Sourdough & Co. | 1,320 sf |
| Shop B3 | Sally Beauty Supply | 1,540 sf |
| Shop C1 | Panda Express | 2,827 sf |
| Shop C2 | Aloha-O Poke & Tea | 1,307 sf |
| Pad 1 | Wendy's | 3,450 sf |
| Pad 3 | Costco Gas | 6,000 sf |
| Pad 4 | Taco Bell | 1,989 sf |
| Pad 5 | Applebee's | 5,400 sf |
| Pad 6 | The Habit Burger (coming soon) | 2,530 sf |

JOHN SCHAEFER
 (415) 235-8115
 john@keystonerea.com
 CA LIC: 0125740

GREY BRADSHAW
 (415) 728-7036
 grey@keystonerea.com
 CA LIC: 02200913

KEYSTONE
 REAL ESTATE ADVISORS
 CA LIC: 02117431

Keystone Real Estate Advisors
 1129 Industrial Avenue, #205
 Petaluma, CA 94952
 www.keystonerea.com

MAJ 3 DEMISING PLAN

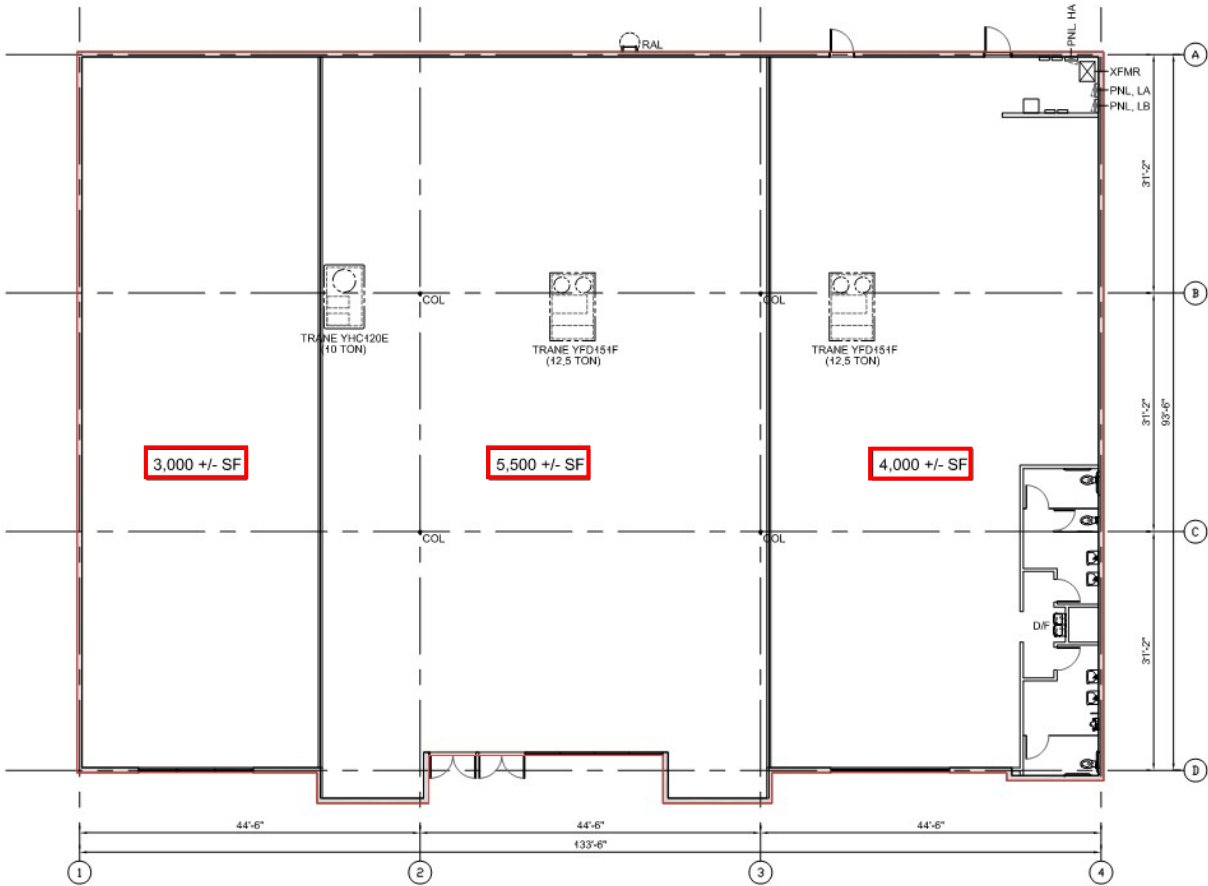

JOHN SCHAEFER
 (415) 235-8115
 john@keystonerea.com
 CA LIC: 0125740

GREY BRADSHAW
 (415) 728-7036
 grey@keystonerea.com
 CA LIC: 02200913

KEYSTONE
 REAL ESTATE ADVISORS
 CA LIC: 02117431

Keystone Real Estate Advisors
 1129 Industrial Avenue, #205
 Petaluma, CA 94952
 www.keystonerea.com

CENTER PHOTOS



JOHN SCHAEFER
(415) 235-8115
john@keystonerea.com
CA LIC: 0125740

GREY BRADSHAW
(415) 728-7036
grey@keystonerea.com
CA LIC: 02200913



KEYSTONE
REAL ESTATE ADVISORS
CA LIC: 02117431

Keystone Real Estate Advisors
1129 Industrial Avenue, #205
Petaluma, CA 94952
www.keystonerea.com

RETAIL TRADE MAP

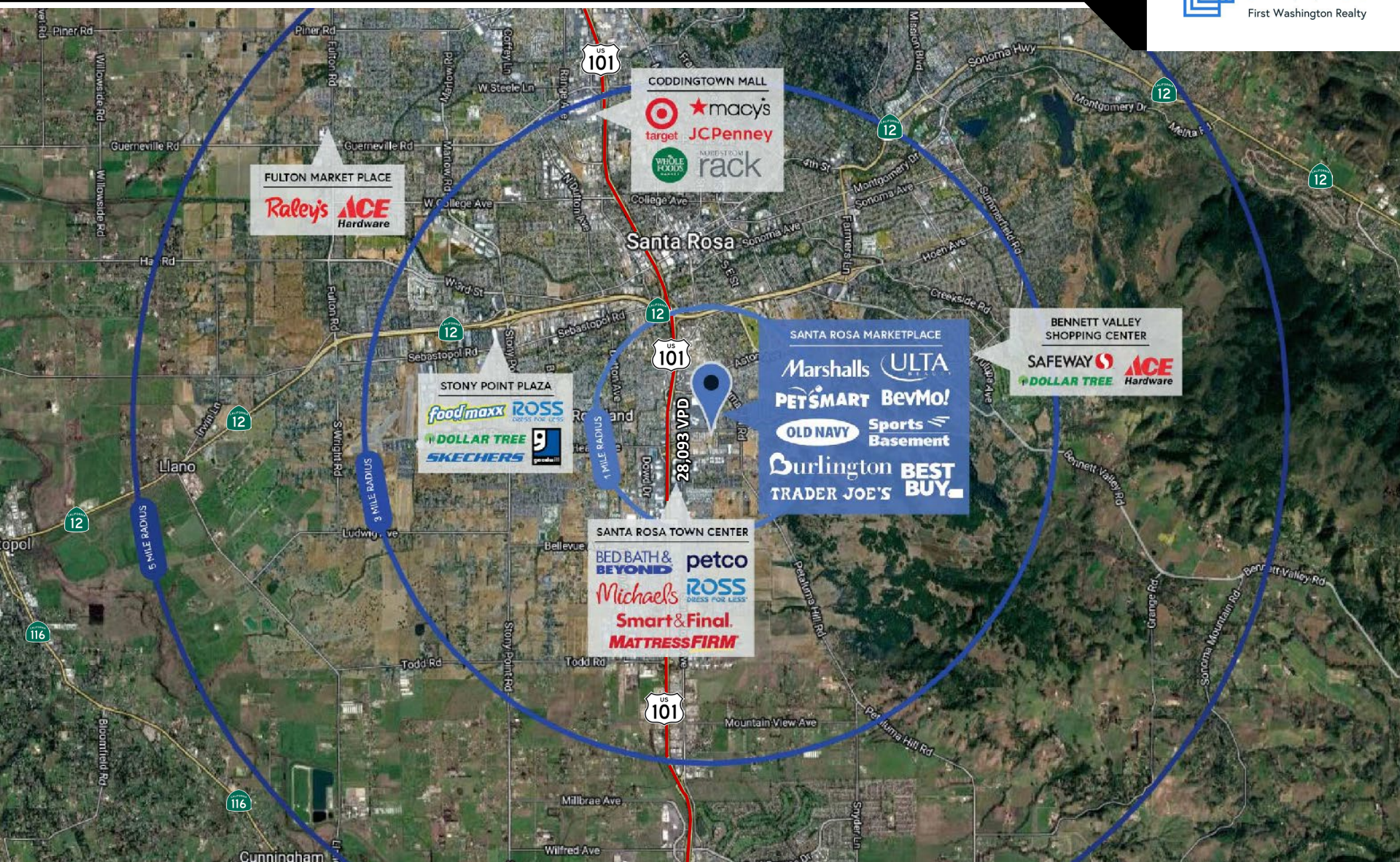

JOHN SCHAEFER
 (415) 235-8115
 john@keystonerea.com
 CA LIC: 0125740

GREY BRADSHAW
 (415) 728-7036
 grey@keystonerea.com
 CA LIC: 02200913

KEYSTONE
 REAL ESTATE ADVISORS
 CA LIC: 02117431

Keystone Real Estate Advisors
 1129 Industrial Avenue, #205
 Petaluma, CA 94952
 www.keystonerea.com