

LARGE RETAIL SPACE AVAILABLE NEXT TO UC BERKELEY

2178 Kittredge Street, Berkeley, CA

+/- 8,524 SF

PERFECT SPACE FOR GROCERY, FITNESS, OR DISCOUNT RETAILERS



JOHN SCHAEFER
(415) 235-8115
john@keystonerea.com
CA LIC: 0125740

GREY BRADSHAW
(415) 728-7036
grey@keystonerea.com
CA LIC: 02200913

 **KEYSTONE**
REAL ESTATE ADVISORS
CA LIC: 02117431

Keystone Real Estate Advisors
1129 Industrial Avenue, #205
Petaluma, CA 94952
www.keystonerea.com

PROPERTY SUMMARY



HIGHLIGHTS

- 2178 Kittredge St is a brand new 165-unit residential project with 3 retail spaces on the bottom floor, positioned directly across the street from UC Berkeley (62,000 Daily Headcount).
- Available Space
 - +/- 8,524 SF
 - Large open floor plan with high ceilings
 - Storage available
 - Asking rent: Contact broker
- Great opportunity for grocery, fitness, discount stores, and more.
- 2 blocks from Downtown Berkeley Bart Station
- Entry to Subject Space is located off Kittredge St.
- Parking garage located across the street.
- Fulton St: 22,247 VPD
- Shattuck Ave: 37,984 VPD



NEARBY TENANTS:



© 2024 Keystone Real Estate Advisors, Inc. (KREA) The information contained in this document has been obtained from sources believed reliable. While KREA does not doubt its accuracy, KREA has not verified it and makes no guarantee, warranty or representation about it. It is your responsibility to independently confirm its accuracy and completeness. Any projections, opinions, assumptions or estimates used are for example only and do not represent the current or future performance of the property. The value of this transaction to you depends on tax and other factors which should be evaluated by your tax, financial and legal advisors. You and your advisors should conduct a careful, independent investigation of the property to determine to your satisfaction the suitability of the property for your needs. KREA and the KREA logo are service marks of Keystone Real Estate Advisors, Inc. and/or its affiliated or related companies in the United States and other countries. All other marks displayed on this document are the property of their respective owners. Photos herein are the property of their respective owners and use of these images without the express written consent of the owner is prohibited.

JOHN SCHAEFER
 (415) 235-8115
 john@keystonerea.com
 CA LIC: 0125740

GREY BRADSHAW
 (415) 728-7036
 grey@keystonerea.com
 CA LIC:02200913



Keystone Real Estate Advisors
 1129 Industrial Avenue, #205
 Petaluma, CA 94952
 www.keystonerea.com

SITE MAP

KITTREDGE ST

Total Subject Space= +/- 8,524

FULTON ST

BANCROFT WAY

NEW RESTAURANT
(coming soon)

NEW RETAIL
(coming soon)

Storage

SUBJECT SPACE
+/- 8,524 SF

ENTRANCE TO
SUBJECT
SPACE

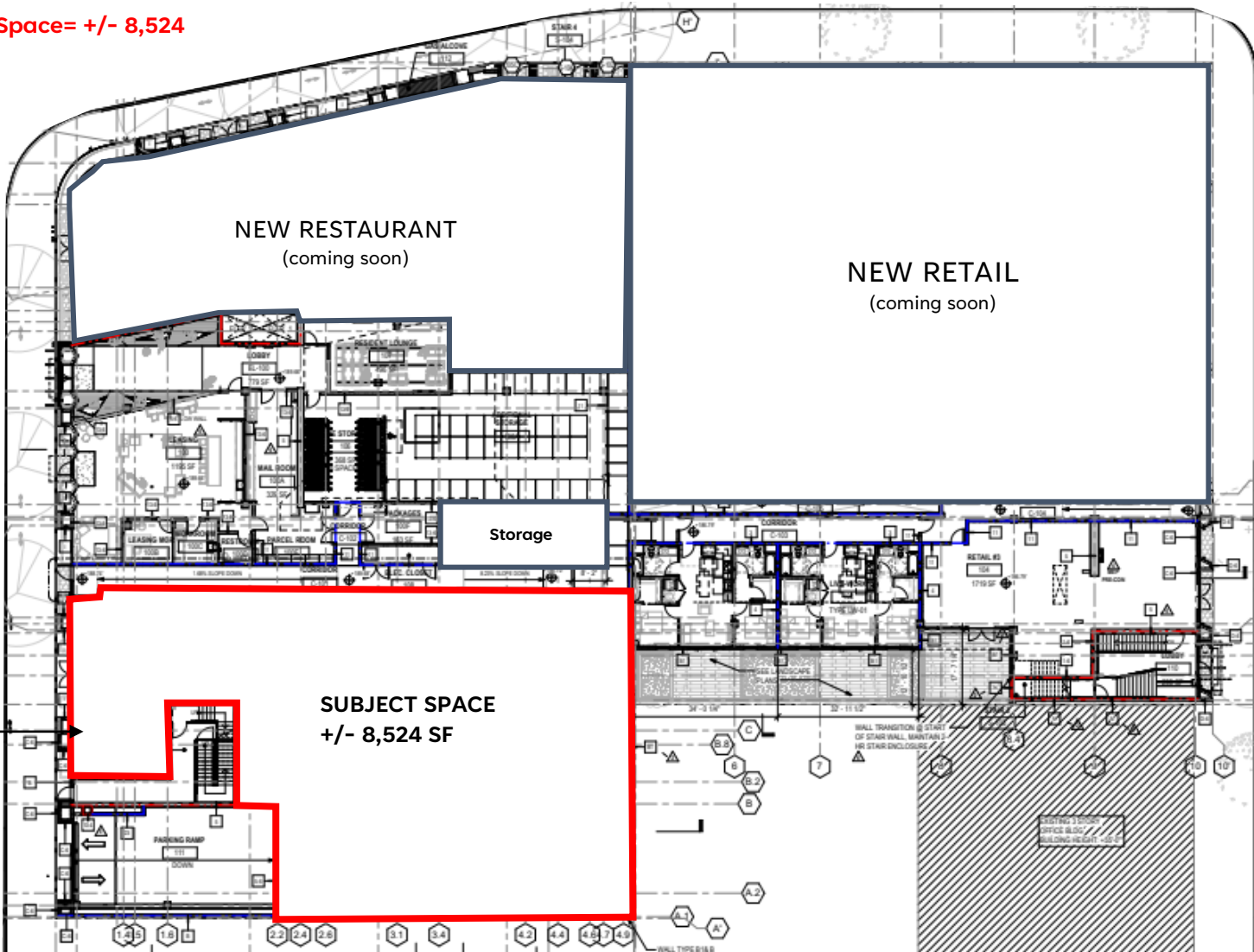

JOHN SCHAEFER
(415) 235-8115
john@keystonerea.com
CA LIC: 0125740

GREY BRADSHAW
(415) 728-7036
grey@keystonerea.com
CA LIC:02200913



Keystone Real Estate Advisors
1129 Industrial Avenue, #205
Petaluma, CA 94952
www.keystonerea.com

AERIAL OVERVIEW



Berkeley
UNIVERSITY OF CALIFORNIA



PARKING GARAGE

22,247 VPD

FULTON ST

KITTREDGE ST

SUBJECT SPACE

+/- 8,000 SF

BANCROFT WAY
15,629 VPD

BRAND NEW 165 UNIT RESIDENTIAL BUILDING

JOHN SCHAEFER
(415) 235-8115
john@keystonerea.com
CA LIC: 0125740

GREY BRADSHAW
(415) 728-7036
grey@keystonerea.com
CA LIC: 02200913

 **KEYSTONE**
REAL ESTATE ADVISORS
CA LIC: 02117431

Keystone Real Estate Advisors
1129 Industrial Avenue, #205
Petaluma, CA 94952
www.keystonerea.com

Aerial Overview



JOHN SCHAEFER
 (415) 235-8115
 john@keystonerea.com
 CA LIC: 0125740

GREY BRADSHAW
 (415) 728-7036
 grey@keystonerea.com
 CA LIC: 02200913



Keystone Real Estate Advisors
 1129 Industrial Avenue, #205
 Petaluma, CA 94952
 www.keystonerea.com